

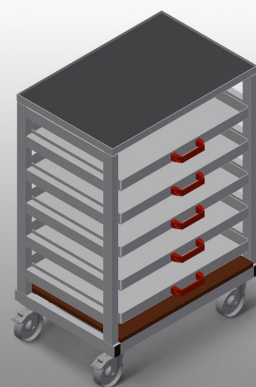

### TWS500

#### TOOL TROLLEYS



- Stable steel construction
- The trolley is suitable for setting down welding supports and tools
- Makes organising the workplace easy
- The ideal complement to the 4-head welding machine
- Storage trays for setting down accessories and gasket limitation with plunger or blade
- Five drawers for welding supports
- Four castors, two of which have a fixing brake

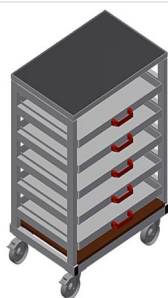

### **TWS 500 trolley for supports and tools**

The trolley is suitable for setting down welding supports and tools

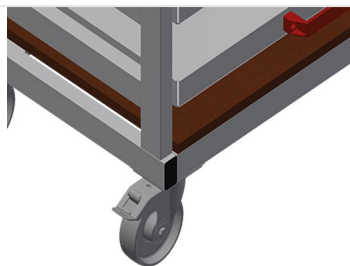

### **Castors**

Four castors, two of which have a fixing brake, provide a high degree of mobility and easy, safe handling

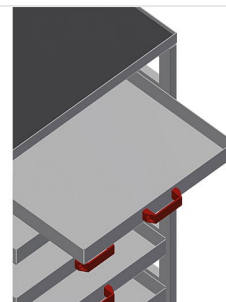

### **Drawer**

Drawer for welding supports and tools

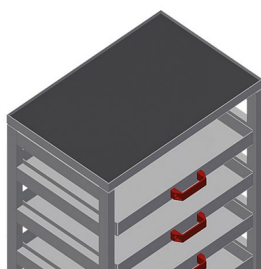

### **Storage surfaces for accessories**

Storage trays for setting down accessories and gasket limitation with plunger or blade



### **TWS 500** / TOOL TROLLEYS

---

- Length 760 mm
- Width 520 mm
- Vertical height 1,095 mm
- Weight 60 kg
- Roller diameter 125 mm